

CB-120/140 All-In-One System

Data Sheet

The Matho CB-120/140 units are flexible compact units designed to handle both endless trim, self-adhesive matrix, or other waste from one or several machines.

The CB-120/140 unit is compact, robustly manufactured, and can be moved easily from one machine to another. It transports the trim up to 35 m¹ and disposes it into a bag.

It is available in 2 models and 3 standard versions of each model; 2 kW or 4 kW model, and a basic, antistatic or matrix version.

The antistatic model is designed to handle static materials, while the matrix² unit is designed for labels or other sticky materials.

Controls are simple and intuitive, since there is no PLC or HMI, only simple push buttons and a speed dial. The CB-120/140 contains big silencers inside a sealed steel enclosure, making it silent enough to be placed within the production environment. Exhaust air is returned to the environment, and the built-in standard filter makes sure the dust is removed³. The standard filter is an F7 filter.

It is possible to add a HEPA filter as an accessory kit.

The 900-litre bag ensures a long operation time between bag changes.

If continuous operation is required, the endless bag kit is available as an accessory. Simply pull the waste away, close the bag with two zip ties, and cut the endless bag between the zip ties.

The sleek design allows the CB-120/140 to be moved around in the production facilities with a forklift or pallet jack. With a width of just 800 mm and a height of 2,150 mm, it will fit through most doors in a factory.

It is easy to do maintenance on the CB-120/140 due to the large built-in side door and removable panel.

The fan, cutter, and oil system (available as an accessory) are easily accessible.

ACCESSORIES

- Oil mist system, for trim handling with glue.
- Antistatic kit, for trim with high static charges.
- HEPA filtration kit, for even better return air filtration.
- Endless bag kit, for continued operation.
- Level sensor with light tower kit



¹ Depending on amounts of bends and material.

² Matrix unit only available as 4 kW

³ Local laws can forbid circulation of production air back into the production environment.

TECHNICAL DATA

Technical Specifications	CB-120/140
Material thickness	20 - 300 µm
Max. power consumption - Blower	2.2 kW (CB-120), 4.0 kW (CB-140)
Power consumption - Cutter	0.75 kW / 1,500 rpm
Power supply	CE: 3 x 400V - 50 Hz, 16A
Weight	400 kg
Size (Height x Width x Length)	2,150 x 800 x 1,570 mm
Pipe connection at inlet	OK 160
Bag dimensions (single-use bag)	Ø1,150 x 2,240 mm (approx. 900 litres)
Noise level	Max. 80 dBA excl. material
Compressed air supply for oil system (accessory)	Min. 4 bar - Max. 6 bar. Consumption: 200 l/hour

BENEFITS

- Cost-effective cutting and extraction system
- High availability / uptime
- Reduction of waste volume due to an integrated cutting module
- Low energy consumption due to an energy-efficient radial ventilator
- Low maintenance costs
- Extraction of the cut material through the radial ventilator
- Compact design with minimal footprint
- Mobile and moveable system
- Low noise emission due to modern pipe silencers

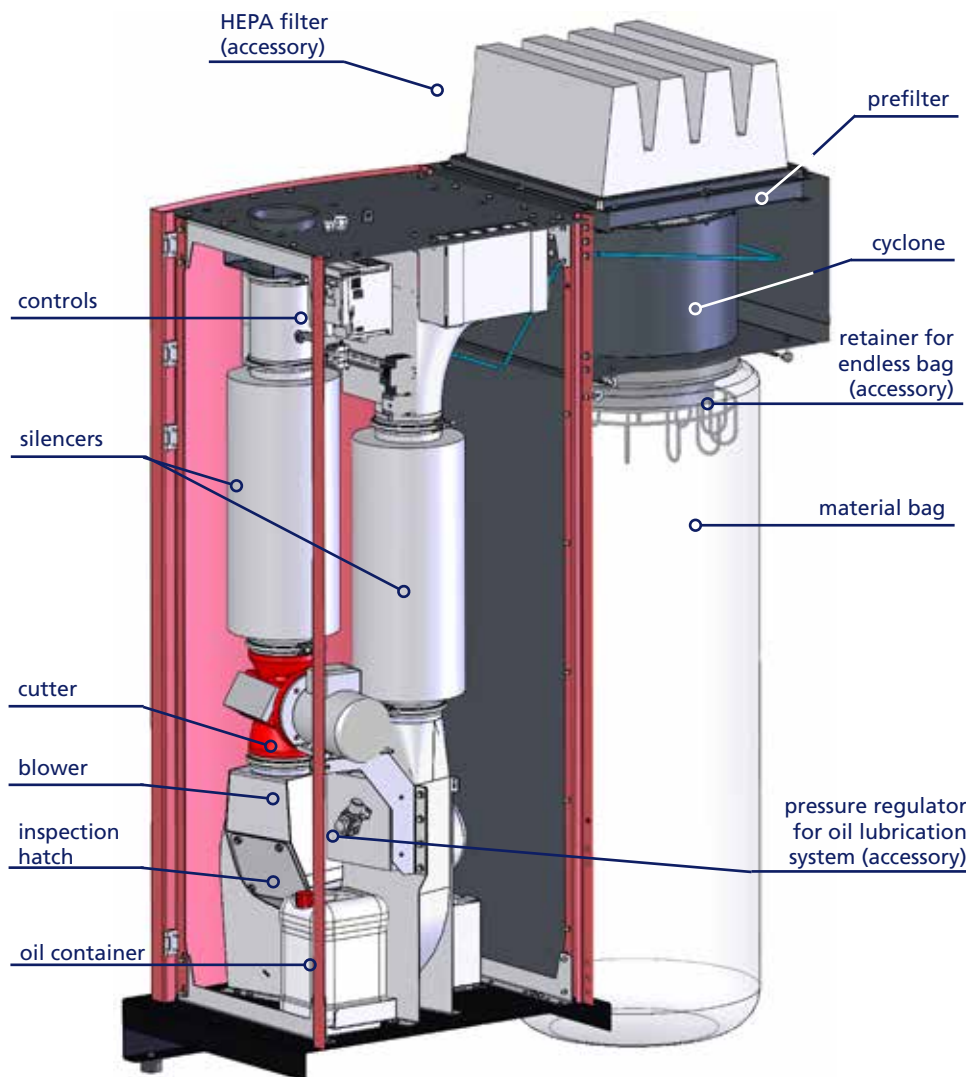

CAPACITY

OPERATION TIMES WITH BAG SOLUTION

WITH ONE TRIM:

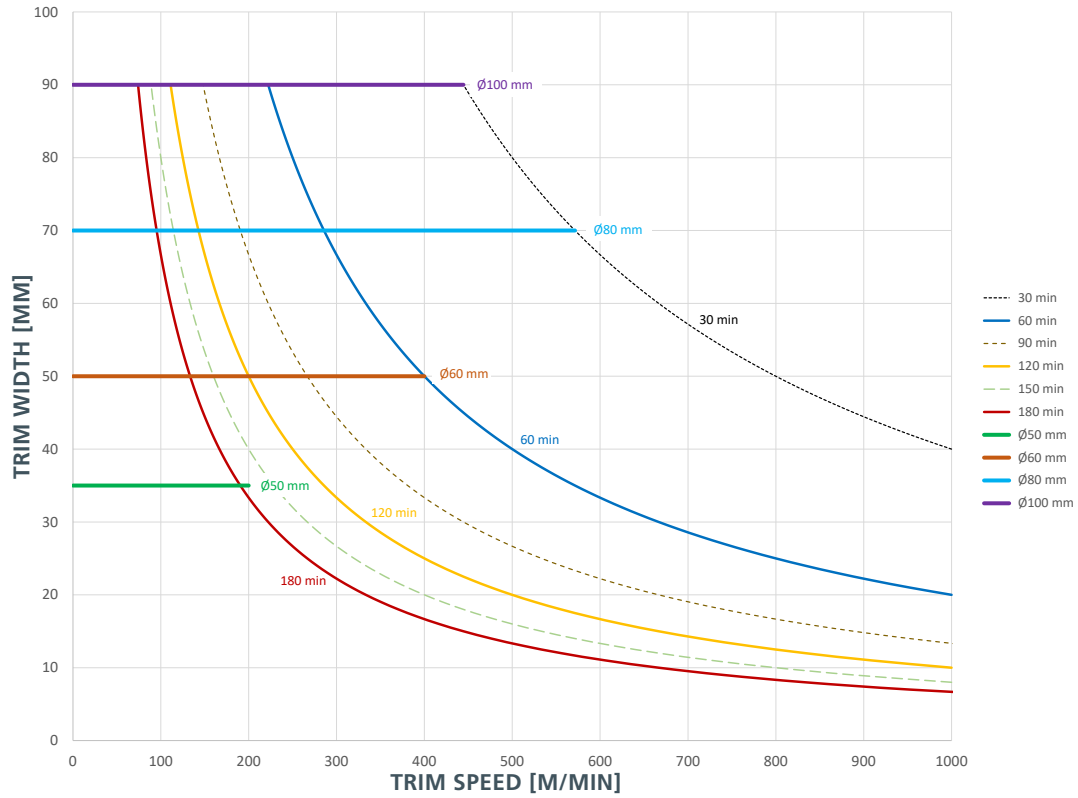

The diagram shows that to be able to suck one strip of 70mm, you need a Ø80mm pipe, etc.

WITH TWO TRIMS:

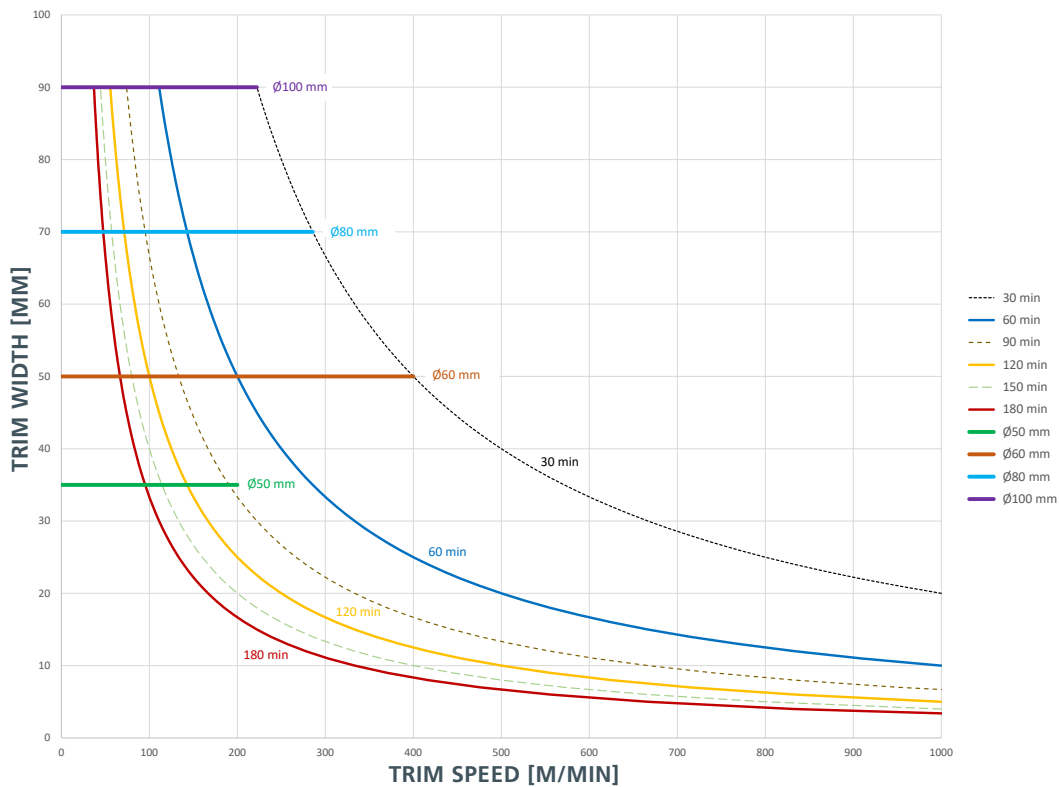

The diagram shows that to be able to suck two strips of 70mm, you need a Ø80mm pipe, etc.

DIMENSIONS

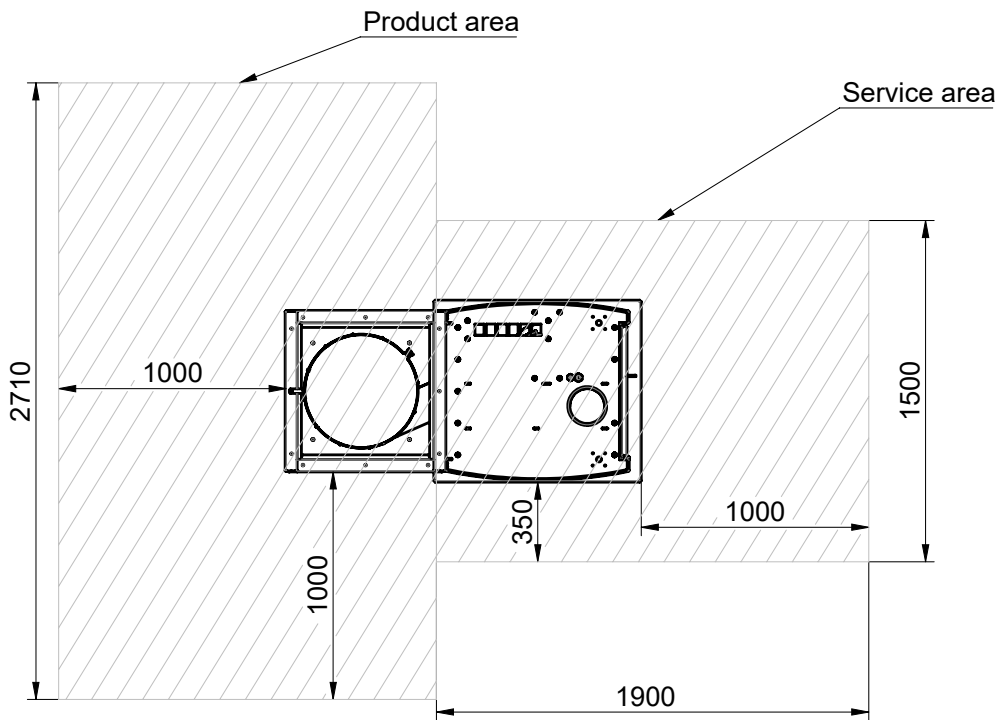
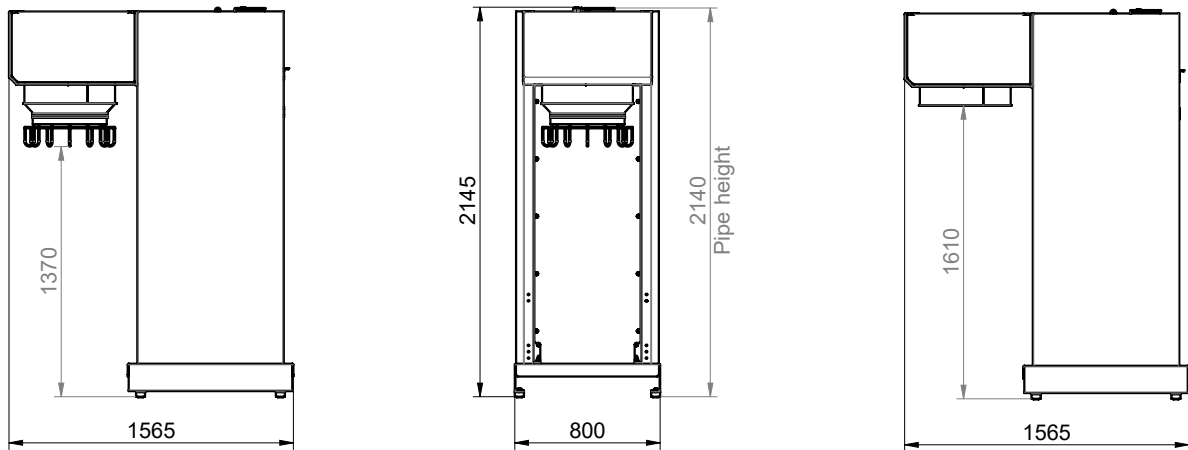

Subject to change without notice. 1-00001 MATHO/GB/CB-120-140/DATA/0524

WEBSITE
WWW.MATHO.COM

EMAIL
OFFICE@MATHO.COM

TELEPHONE
[+49 7363 9547440](tel:+4973639547440)

